

## eco cistem ECO1001 Box contents

Fully assembled eco cistem, flush volume pre-set at 4.5 litres

1. 2" – 1.1/2" Tapered Flush Pipe
2. Pan flush pipe connector
3. Flush Pipe Cone Ring
4. 2" Slip Ring
5. 2" Cap Nut
6. Air tube
7. 2 x Wall Mounting Brackets (ECO1001)  
Frame Mounted Brackets (ECO1002)
8. Wall mounting / installation instructions



## eco cistem Assembly Instructions

Tools Required



## eco cistem ECO1001 Parts list

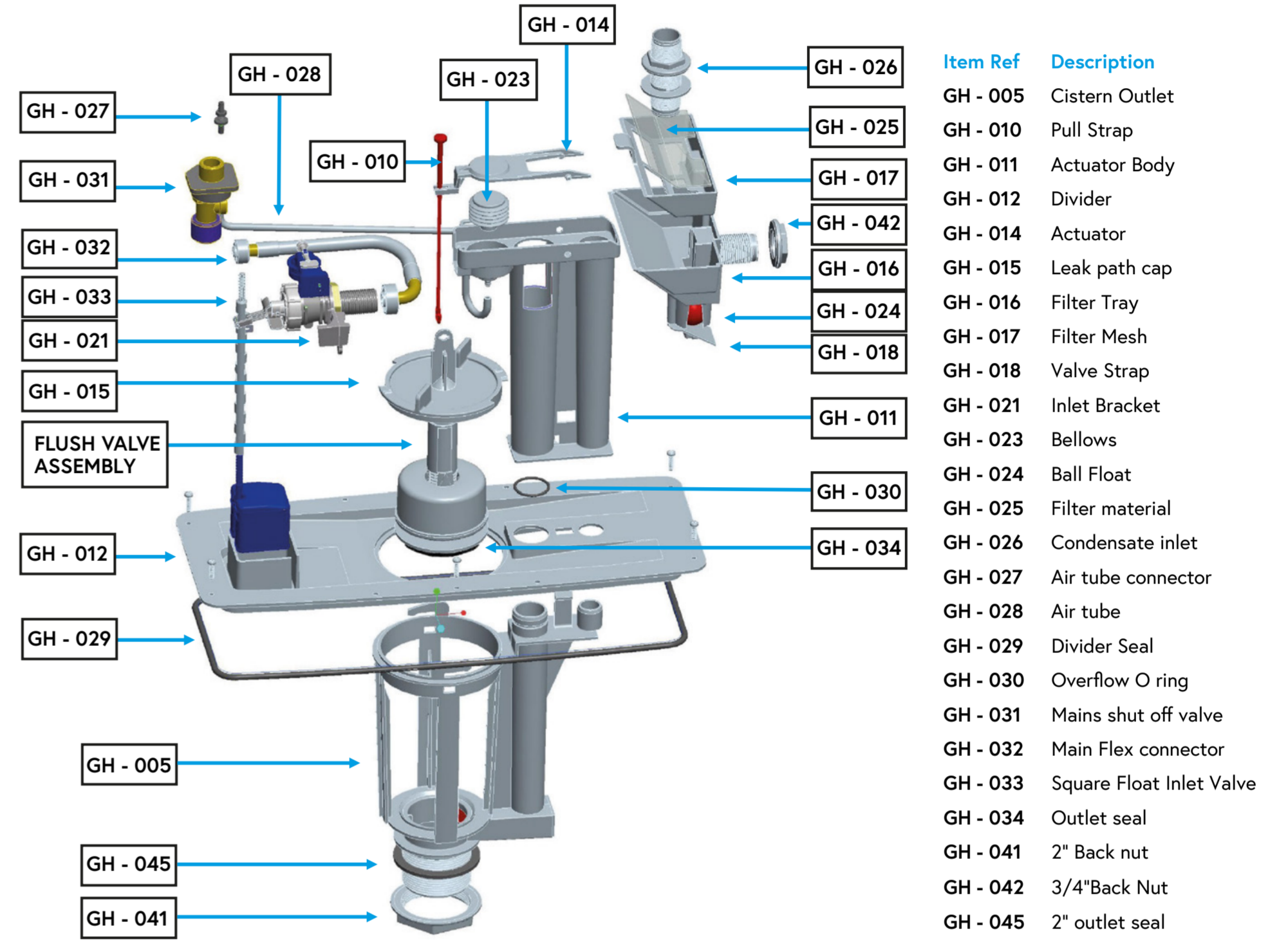

## Assembly Instructions

1. Ensure filter tray is in position.
2. Adjust clockwise and anticlockwise to align marker tag to discharge volume.  
Pre-set to at 4.5 Litres - Adjust if required.
3. Attach leak path cap to the valve stem. Insert through the divider plate and twist to lock in position.
4. Attach the pull strap to the top of the valve stem and the actuator body.
5. Ensure float sits within the guides is indicated.
6. Check that the hose to the connector in the cistern lid and is secure.
7. Do not cover the side of the weir, and leave 50mm space from a fixed point, i.e. wall, as this will negate CAT 5 certification.
8. Tighten all fixings.
9. Fit Eco Cistem brackets to the wall to suit installation location using template supplied overleaf (Model ECO1001).
10. Cistern fitted to customers own installation frame using eco-cistem metal bracket option. Template supplied overleaf (Model ECO1002).
11. Connect air tube on cistern lid to single push pneumatic flush plate (supplied by installer). Compatible with infrared flush sensor. (Contact eco-cistem for further details).
12. Connect mains fill valve in accordance with Local Water Bylaw requirements.
13. Connect condensate pipework to cistern & connect overflow from cistern to local drain.
14. Cut tapered flush pipe to required length and attach to the cistern and waste pipe with supplied components.



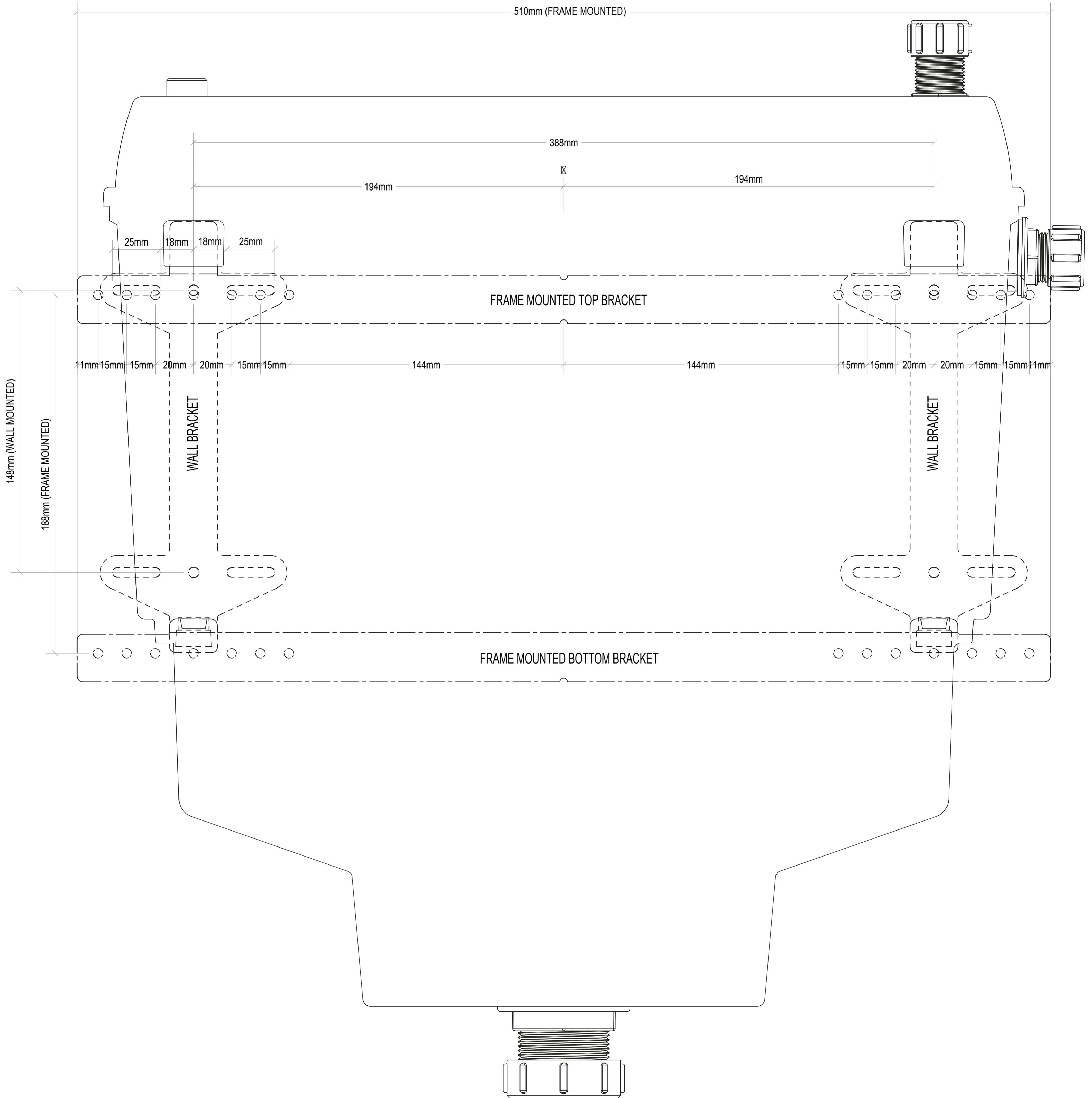

For our Declaration of Performance please visit:

[www.eco-cistem.com](http://www.eco-cistem.com)